

Standard Square Drive Mechanism
 (Only flat lock bars are available)

T - Lock System
 Locking or Non Locking

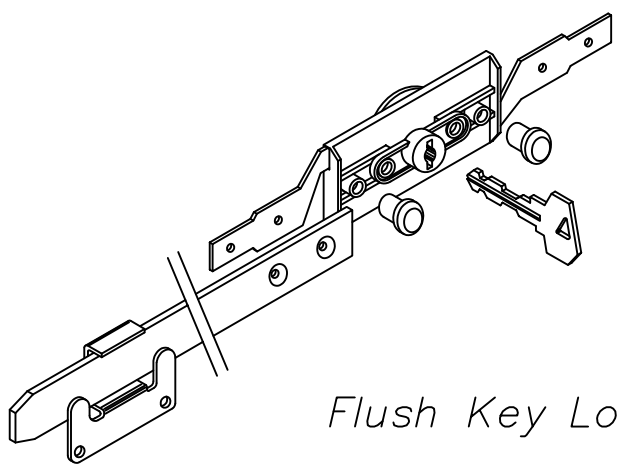

Flush Key Lock



DIAMOND ROLL-UP DOOR, INC.
 295 COMMERCE WAY
 UPPER SANDUSKY, OH 43351
 PHONE: 419-294-3373 FAX: 419-294-3329

DESCRIPTION:
 1EA Lock Options

REV. NO.	DESCRIPTION	BY	DATE

SCALE: NTS	DRAWN: D.Lohr	DATE: 03-30-2004
---------------	------------------	---------------------

CONFIDENTIAL NOTE: This drawing and its specifications and engineering information disclosed hereon are the property of DIAMOND ROLL-UP DOOR INC. and are not to be disseminated or reproduced without express written consent. The drawing is loaned in confidence and then only for consideration of the material disclosed hereon. In accepting loan of this drawing, the recipient agrees to keep it and the material disclosed hereon in confidence and not to use nor permit their use in any way detrimental to DIAMOND ROLL-UP DOOR INC.

GENERAL TOLERANCES Linear Measurements: unless otherwise stated +/- .125" Angular Measurements: unless otherwise stated +/- 0.5 deg.	PART NUMBER: DRAWING NUMBER: DRS-1026
--	---